

TECHNICAL DATASHEET

# Roxia Floating Aerator 1,5 kW (2 hp)

Roxia Floating Aerators are CE marked products from Finland.

## Technical data

Oxygen transfer efficiency	Up to 2,2 kgO <sub>2</sub> /kWh* (4,1 lbO <sub>2</sub> /hp-hr)
Spray pattern diameter	Appr. 3,5 m (12 ft)
Motor	3-phase customized motor manufactured by Lönne or equal (CE, UL and CSA approved)
Nominal power	1,5 kW (2 hp)
Efficiency class	IE3
Insulation class	H
V/F	50 Hz: 400 V +- 5%, 3,4A, 60 Hz: 460V +- 5%, 3,4A
Electrical cable	4G2,5 European standard cable. Note: Length and local electrical control system may affect. When using AC-drive EMC-cable or shielded cable is required
Main dimensions	1000 mm x 1000 mm x 550 mm (39,4" x 39,4" x 21,7")
Weight of aerator with floats	Appr. 40 - 50 kg (107 - 134 lb)
Materials	<ul style="list-style-type: none"> <li>× AISI 316 (shaft and other metal parts)</li> <li>× Impeller aluminum</li> <li>× Float PUR-plastic</li> <li>× Intake pipe** PE-Plastic</li> </ul>

## Optional features

- Frequency converter (AC-drive)
  - × Protection class IP20 or IP55
  - × Automatic impeller cleaning cycle feature

Roxia Digital Services & Roxia Malibu™

Shallow pond protect (0,3 - 0,6 m / 1 - 2 ft depth)

Intake pipe screen

Lifting hook

Return channel (to deep lakes)

Lights

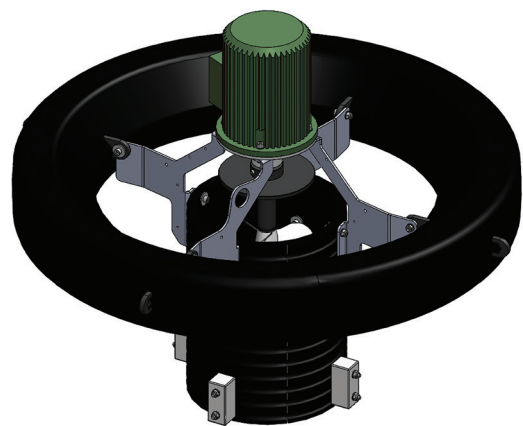

\* Oxygen measurement accuracy ± 15%

\*\* Customer must define the length of the intake pipe (the pipe should be 0,6 - 2,0 m (2 - 6,5 ft) above the bottom of the basin, depends on basins material).

*Information without engagement. All rights to changes without prior notice reserved.*